

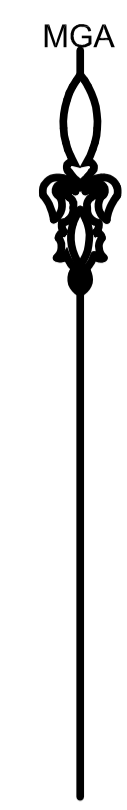

# L.G.A. OF LIVERPOOL



- NOTES**
- SPOT LEVELS SHOWN THUS:  $\bullet$  36.15
  - CONTOURS SHOWN THUS:  $\text{---}$  36.5
  - CONTOUR INTERVAL 0.5 METRE
  - SIGNIFICANT TREES SHOWN THUS:
- THE SPREAD OF EACH TREE IS INDICATIVE ONLY AND CANNOT BE SHOWN ACCURATELY WITHOUT VERY DETAILED FURTHER SURVEY. THE SHAPE AND SIZE OF SPREAD OF THE TREE MAY VARY DUE TO LACK OF UNIFORMITY OF THE BRANCHES, TRUNK AND OTHER REASONS.
- VISIBLE SERVICES ONLY HAVE BEEN LOCATED BY SURVEY.
  - BOUNDARY INFORMATION HAS BEEN COMPILED FROM INFORMATION SHOWN ON PLANS ON PUBLIC RECORD AT OFFICE OF LAND AND PROPERTY INFORMATION.
  - BOUNDARIES PLOTTED ARE ACCURATE FOR D.A. PURPOSES. BOUNDARIES SHOULD BE MARKED ON THE GROUND PRIOR TO ANY FURTHER DEVELOPMENT OF THE LAND.
  - SERVICING INFORMATION OBTAINED FROM INFORMATION PROVIDED BY SERVICES AUTHORITIES (TELSTRA/SYDNEY WATER).

**LOT AREAS**

LOT 57:	810.4m <sup>2</sup>
LOT 58:	650.4m <sup>2</sup>
LOT 59:	587.1m <sup>2</sup>
LOT 60:	610.1m <sup>2</sup>
LOT 61:	689.5m <sup>2</sup>

No.	DATE	NOTATION/AMENDMENT
1.	6.08.2019	PIT INFORMATION, LIVERPOOL-PARRAMATTA TRANSIT WAY
2.	13.08.2019	BLUE CHIP LIMITED LOGO ADDED

CONTOUR INTERVAL: 0.5m  
 DATUM: AHD  
 ORIGIN OF DATUM: PM 52191 RL.14.14  
 100 YEAR FLOOD RL: N/A  
 RECOMMENDED MINIMUM FLOOR RL:  
 SOURCE OF FLOOD INFO: LIVERPOOL COUNCIL SEC. 149 CERTIFICATE

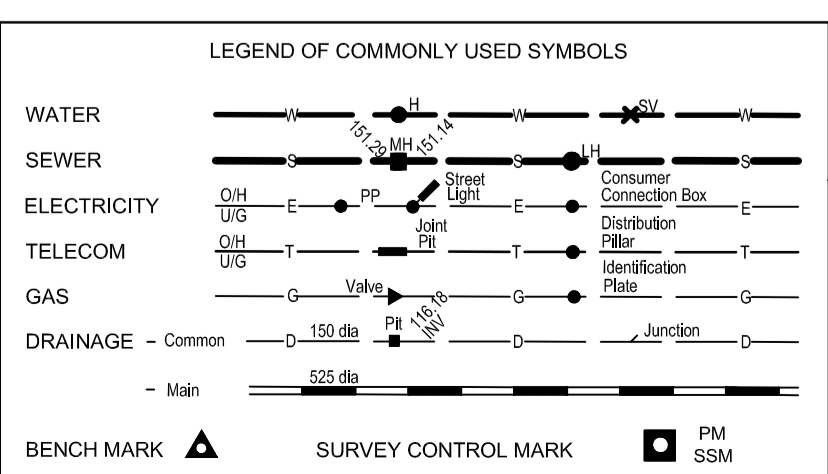

**REDUCTION RATIO** 1 : 200 @ A1

LAND TITLE INFORMATION

LOTS 57-61  
 PLAN NOS : DP 35980  
 OTHER:  
 AREA: 3347m<sup>2</sup>

DATE OF SURVEY: 14 / 12 / 2016  
 SURVEY CONSULTANT:  
 YSCO GEOMATICS  
 SUITE 4, 114 HAMPDEN ROAD, ARTARMON  
 PH. 94198222

SURVEYORS  
 REF: ..0216..

**NSW** Government  
**Family & Community Services**  
 Land & Housing Corporation

DRAWING TITLE  
**PLAN SHOWING DETAIL AND LEVELS**

**BlueCHP Limited**  
 AFFORDABLE HOUSING - FOUNDATION FOR LIFE

LOCATION <b>LIVERPOOL</b>		TYPE <b>S</b>
STREET ADDRESS <b>1-7 ANDERSON AVENUE &amp; 12 EL ALAMEIN AVENUE</b>		SHT. 1
SITE LAYOUT JOB		OF 2
BGR64 / 001 / 01		

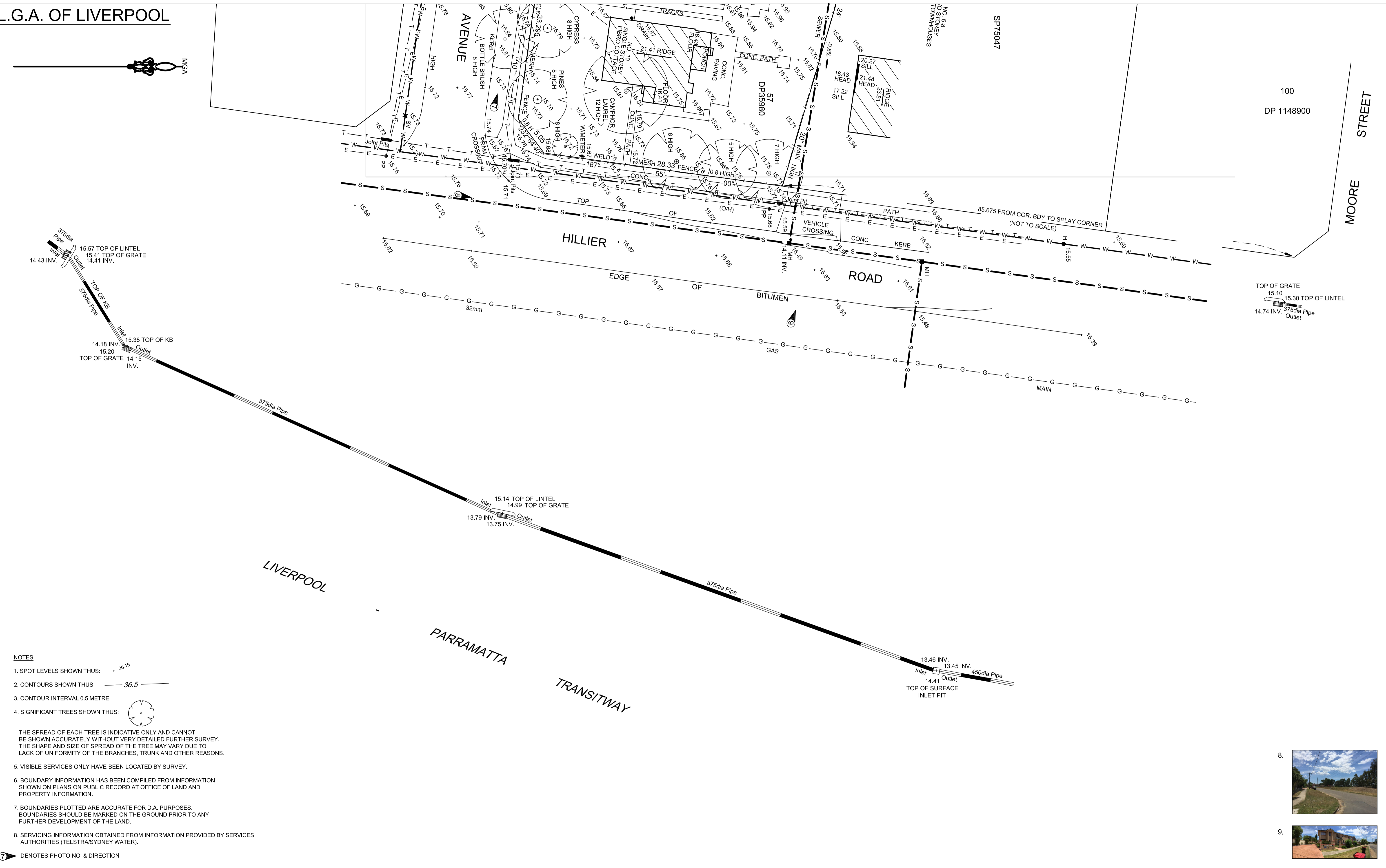
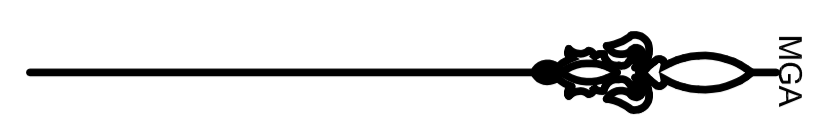

- NOTES**
- SPOT LEVELS SHOWN THUS:  $\bullet$  36.15
  - CONTOURS SHOWN THUS:  $\text{---} 36.5 \text{---}$
  - CONTOUR INTERVAL 0.5 METRE
  - SIGNIFICANT TREES SHOWN THUS:

THE SPREAD OF EACH TREE IS INDICATIVE ONLY AND CANNOT BE SHOWN ACCURATELY WITHOUT VERY DETAILED FURTHER SURVEY. THE SHAPE AND SIZE OF SPREAD OF THE TREE MAY VARY DUE TO LACK OF UNIFORMITY OF THE BRANCHES, TRUNK AND OTHER REASONS.

5. VISIBLE SERVICES ONLY HAVE BEEN LOCATED BY SURVEY.

6. BOUNDARY INFORMATION HAS BEEN COMPILED FROM INFORMATION SHOWN ON PLANS ON PUBLIC RECORD AT OFFICE OF LAND AND PROPERTY INFORMATION.

7. BOUNDARIES PLOTTED ARE ACCURATE FOR D.A. PURPOSES. BOUNDARIES SHOULD BE MARKED ON THE GROUND PRIOR TO ANY FURTHER DEVELOPMENT OF THE LAND.

8. SERVICING INFORMATION OBTAINED FROM INFORMATION PROVIDED BY SERVICES AUTHORITIES (TELSTRA/SYDNEY WATER).

DENOTES PHOTO NO. & DIRECTION

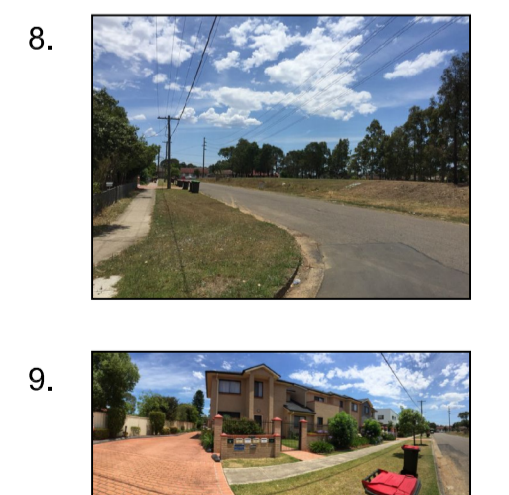

No.	DATE	NOTATION/AMENDMENT
1.	6.08.2019	PIT INFORMATION, LIVERPOOL-PARRAMATTA TRANSITWAY
2.	13.08.2019	BLUE CHIP LIMITED LOGO ADDED
FILE	FILE SIZE (MB)	CHECKED BY

CONTOUR INTERVAL: 0.5m  
 DATUM: AHD  
 ORIGIN OF DATUM: PM 52191 RL.14.14  
 100 YEAR FLOOD RL: N/A  
 RECOMMENDED MINIMUM FLOOR RL:  
 SOURCE OF FLOOD INFO: LIVERPOOL COUNCIL SEC. 149 CERTIFICATE

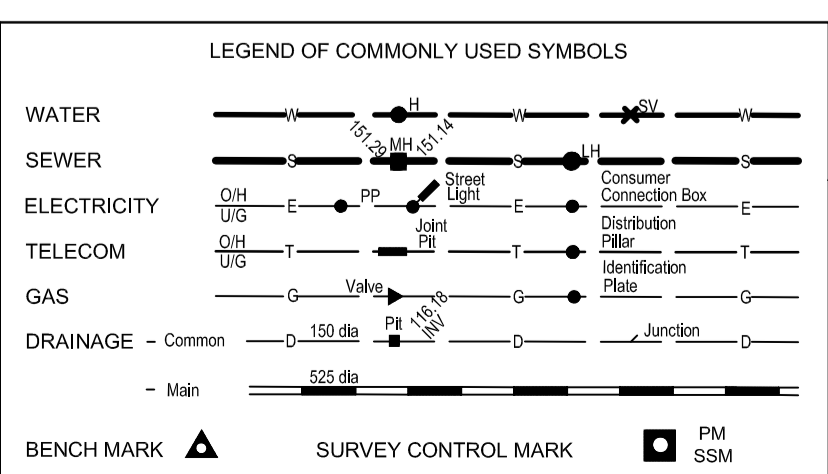

**REDUCTION RATIO** 1 : 200 @ A1

0 2 4 6 8 10 12 14 16 18 20

**LAND TITLE INFORMATION**

LOTS 57-61  
 PLAN NOS : DP 35980  
 OTHER:  
 AREA: 3347m<sup>2</sup>

DATE OF SURVEY: 14 / 12 / 2016  
 SURVEY CONSULTANT:  
 YSCO GEOMATICS  
 SUITE 4, 114 HAMPDEN ROAD, ARTARMON  
 PH. 94198222

.....  
 Registered Surveyor  
 REF: . . .0216 . . .

**NSW GOVERNMENT** Family & Community Services Land & Housing Corporation

DRAWING TITLE  
**PLAN SHOWING DETAIL AND LEVELS**

**BlueCHP Limited**  
 AFFORDABLE HOUSING - FOUNDATION FOR LIFE

LOCATION <b>LIVERPOOL</b>		TYPE <b>S</b>
STREET ADDRESS <b>1-7 ANDERSON AVENUE &amp; 12 EL ALAMEIN AVENUE</b>		SHT. 2
SITE LAYOUT JOB <b>BGR64 / 001 / 01</b>		OF 2